

# TIMER

## RG ANALOGUE TIMER



### CHARACTERISTIC :

- Customized CMOS IC for low power consumption, high operation stability and extreme timing accuracy
- Large transparent knob for easy adjustment and monitoring
- 9 different time ranges available, from 6 sec to 60 min

### SPECIFICATION :

Operating voltage	DC(V): 12, 24 AC(V): 12, 24, 110, 220, 240, 380, 420
Allowable operating voltage range	85~110% of rated operating voltage
Rated frequency	50 / 60 Hz
Contact rating	250VAC 5A (resistive load)
Reset time	MAX 0.1S
Power consumption	Approx. 3VA
Life	Mechanical: 5,000,000 times Electrical: 100,000 times
Ambient temperature	-10 ~ +50°C
Ambient humidity	MAX 85%RH
Weight	Approx. 200g

### TYPE SELECTION :

Model	Variable		
Output contact	1C	2C	1A1C
Type	RG-1	RG-2	RG-3
Time range	6, 10, 30, 60 sec, 3, 6, 10, 30, 60 min		

## CONNECTION :

1C

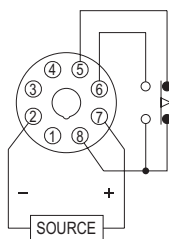

2C

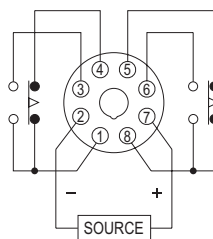

1A1C

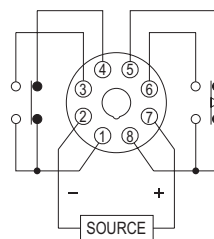

## TIMING CHART :

1C

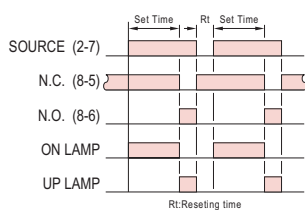

2C

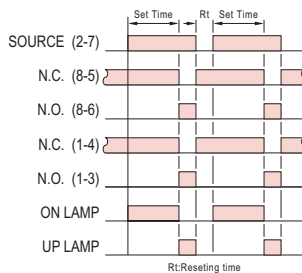

1A1C

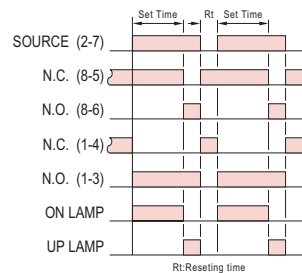

## DIMENSIONS : (mm)

N type(Surface Mounting): Using 8PFA Socket

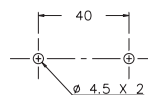
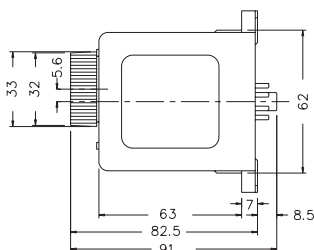
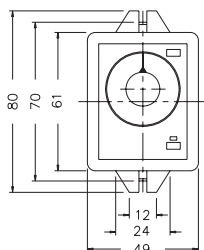

**UPAC International CO., LTD.**

TEL: +886-2-2250-3410  
 FAX: +886-2-2250-5280  
<http://www.upac.com.tw>  
 E-mail: upac@seed.net.tw